



Xtensa is a monthly soft contact lens for all audiences and lifestyles manufactured with our patented micro-precision technology. Its consistent comfort and vision clarity make it ideal for the most dynamic and carefree contact lens users.

- HYDROGEL
- MONTHLY
- RX DESIGN
- ASPHERIC
- TORIC
- MULTIFOCAL

CHARACTERISTICS

More Custom	Design flexibilities beyond other standard hydrogels.
More Comfort	High-performance Hydrogel (55%).
Vision Type	Active—clear vision for your lifestyle.

TECHNICAL SPECIFICATIONS

MATERIAL	Hydrogel Filcon IV 1, 55%		
Dk	19		
HANDLING TINT	Yes		
		Parameter Range	Steps
DIAMETER (mm)		14.40	
		14.30	
BASE CURVE (mm)		8.70	
		8.60	
SPHERE (D)		+8.00 to -10.00	0.25 +6.00 to -6.00; 0.50 +8.00 to +6.00, -6.00 to -10.00
		+6.00 to -8.00	0.25 +4.00 to -6.00; 0.50 +6.00 to +4.00, -6.00 to -8.00
		+10.00 to -10.00	0.25 +4.00 to -6.00; 0.50 +10.00 to +4.00, -6.00 to -10.00
		+10.00 to -10.00	0.25 +4.00 to -6.00; 0.50 +10.00 to +4.00, -6.00 to -10.00
CYLINDER (D)		-0.75 to -2.75	0.50
		-0.75 to -5.75	0.50
AXES (°)		All	10°
		All	10° Cyl -0.75 to -2.75; 5° Cyl -3.25 to -5.75
ADDITION (D)		Low – High	
MULTIFOCAL - DESIGN		CD – CN	

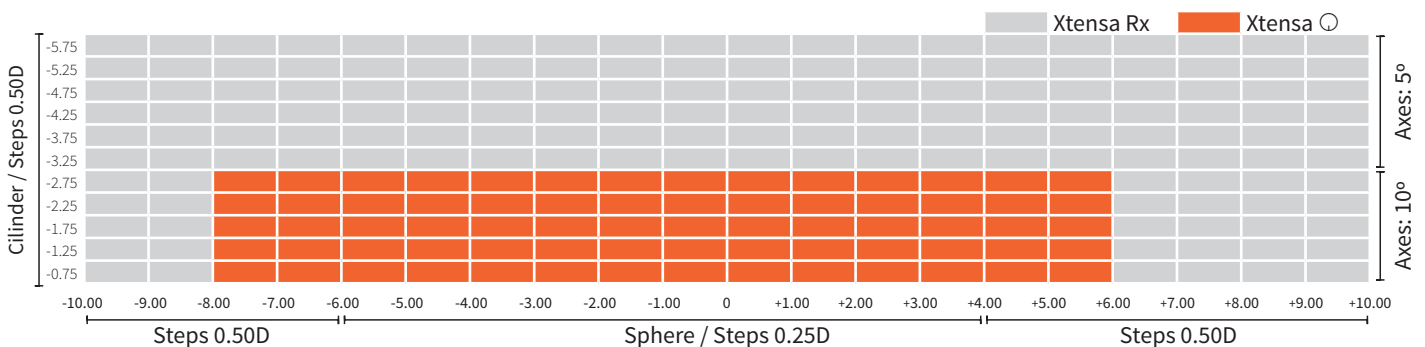

XTENSA LENS DESIGN

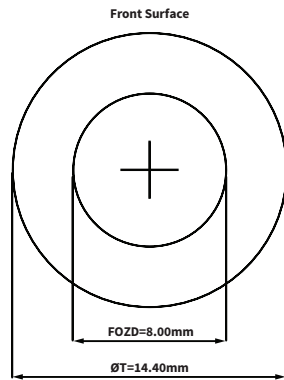
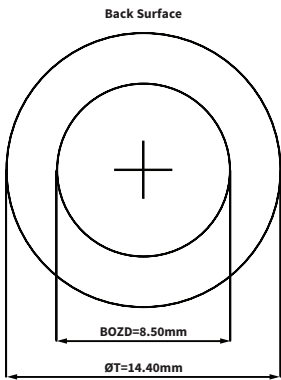

ØT=14.40mm
CT=0.09mm

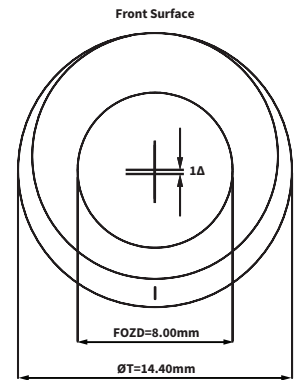
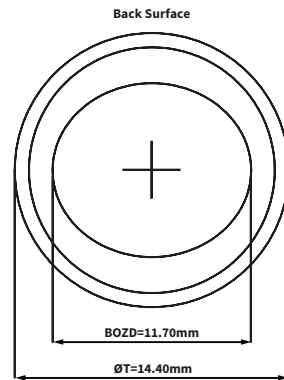

ØT=14.40mm
CT=0.10mm

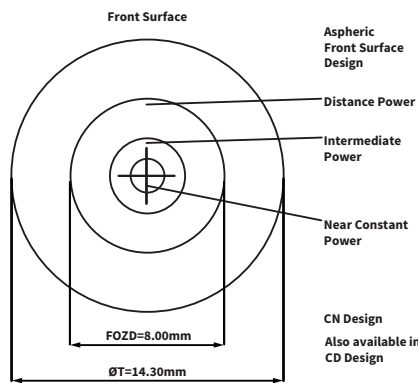
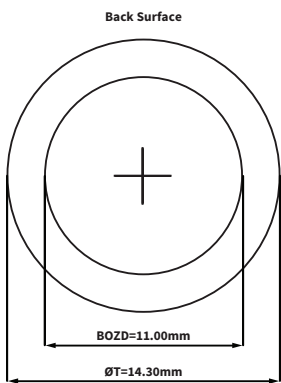

ØT=14.30mm
CT=0.12mm

Aspheric Front Surface Design
Distance Power
Intermediate Power
Near Constant Power

CN Design
Also available in CD Design

Lens design parameters may change depending on the power:

- * Based on Sph -3.00
- ** Based on Sph -3.00 Cyl -2.75
- *** Based on Sph -3.00 Add HIGH



GENERAL FITTING GUIDE	
Myopia - Low Hypermetropy	
Dominant Eye	Non-Dominant Eye
CD: Centre Distance	CN: Centre Near
Hypermetropy > +0.75D	
Dominant Eye	Non-Dominant Eye
CN Design for Both Eyes	

